

SHOWN CZUS6

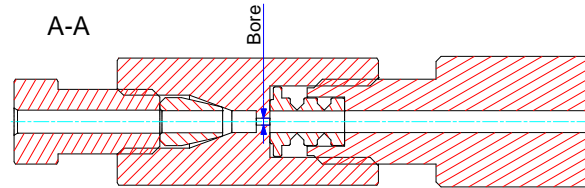

Part#	Description	Bore		L		X1	X2
		mm	Inch	mm	Inch		
CZUCS6	Union 1/4-28 to 10-32, 1/16" OD tubing	Ø0.25	Ø.010"	~42.9	~1.69"	3/8" Hex	1/4" Hex
CZUS6	Union 1/4-28 to 10-32, 1/16" OD tubing	Ø0.50	Ø.020"	~43.2	~1.70"	3/8" Hex	1/4" Hex
CZUMS6	Union 1/4-28 to 10-32, 1/16" OD tubing	Ø0.75	Ø.030"	~43.2	~1.70"	3/8" Hex	1/4" Hex
CZULS6	Union 1/4-28 to 10-32, 1/8" OD tubing	Ø1.0	Ø.040"	~44.0	~1.73"	3/8" Hex	1/4" Hex

THIS DOCUMENT AND THE INFORMATION WHICH IT CONTAINS SHALL NOT BE USED, EXPLOITED OR SOLD, AND SHALL NOT BE REPRODUCED OR DISCLOSED TO OTHERS WITHOUT THE EXPRESS WRITTEN PERMISSION OF VICI. THIS DOCUMENT SHALL REMAIN THE PROPERTY OF VICI AND SHALL BE RETURNED UPON DEMAND.

Material:	Dimensions:
Production:	General Tolerances:
EN ISO 2768-1/ISO 2768	

Part No.:

Low pressure unions SS
1/4-28 to 10-32

General dimensions

Material:	Scale:	Revision:	20.02.2008	F.P.
5:1	19.02.2008	FCO		
CAD No.:	506323.idw			
Customer:	KUNDE			

Ziehungs Nr. / DRAWING NO. 1 - GE - 5063.23

VICI VICI AG International, CH-6214 Schenkon