

Shown PS-654051

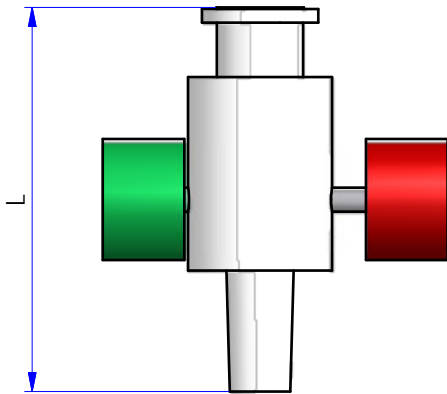
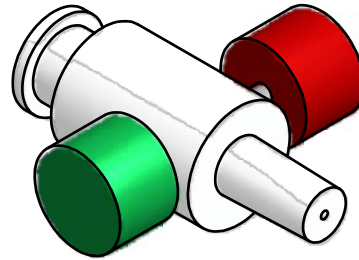

Dimension in mm [Inch]

Prod No	Type	L	
		mm	Inch
PS-654050	For C or D syringe	25.4	1.00"
PS-654051	For Luer-tip syringe	26.2	1.03"

THIS DOCUMENT AND THE INFORMATION WHICH IT CONTAINS SHALL NOT BE USED, EXPLOITED OR SOLD, AND SHALL NOT BE REVEALED OR DISCLOSED TO OTHERS WITHOUT THE EXPRESS WRITTEN PERMISSION OF VICI. THIS DOCUMENT SHALL REMAIN THE PROPERTY OF VICI AND SHALL BE RETURNED UPON DEMAND.

Material
MATERIAL

Dimensionen
DIMENSIONS

Aenderungen:
MODIFICATIONS:

Projektion
PROJECTION

Allgemein Toleranzen
GENERAL TOLERANCES

PART NO.:
PS-65405*

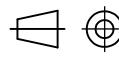

SN EN 22768-1/ ISO 2768

Mininert syringe valves

Masstab
SCALE

Gezeichnet
DRAWN

23.11.2010

F.P.

2:1

Geprüft / Freigabe
CHECKED/ RELEASE

23.11.2010

FCo

CAD Nr.
CAD NO.

820500.idw

General dimensions

Unterverz.:
SUB DIREC.:

Mininert Valves

Zeichnungs Nr. / DRAWING NO.



VICI AG International, CH-6214 Schenkon

4 - GE - 8205.00