

Controller assembly and power supply not shown.

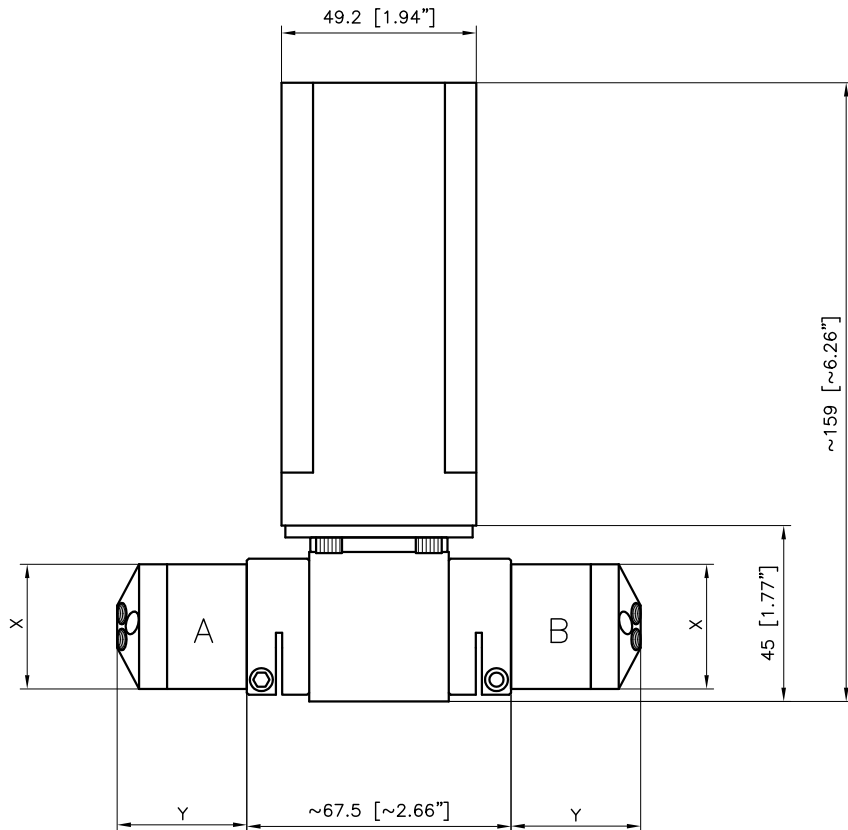

PART NO.	REPL. VALVE A	REPL. VALVE B	POS.	MAT.	BORE ϕ mm	X mm	Y mm
C5-1004EMTD	C5-1004LD	C5-1004D	4	N60	0.25	$\phi 31.75$	33
C5-2004EMTD	C5-2004LD	C5-2004D		N60	0.40		
C5-1344EMTD	C5-1344LD	C5-1344D		PEAK	0.25		
C5-2344EMTD	C5-2344LD	C5-2344D		PEAK	0.40		
C5-0006EMTD	C5-0006LD	C5-0006D	6	N60	0.15	$\phi 31.75$	33
C5-1006EMTD	C5-1006LD	C5-1006D		N60	0.25		
C5-2006EMTD	C5-2006LD	C5-2006D		N60	0.40		
C5-1346EMTD	C5-1346LD	C5-1346D		PEAK	0.25		
C5-2346EMTD	C5-2346LD	C5-2346D		PEAK	0.40		
C5H-1008EMTD	C5H-1008LD	C5H-1008D	8	N60	0.25	$\phi 34.93$	35.15
C5H-2008EMTD	C5H-2008LD	C5H-2008D		N60	0.40		
C5H-1348EMTD	C5H-1348LD	C5H-1348D		PEAK	0.25		
C5H-2348EMTD	C5H-2348LD	C5H-2348D		PEAK	0.40		
C5H-1000EMTD	C5H-1000LD	C5H-1000D	10	N60	0.25	$\phi 34.93$	35.15
C5H-2000EMTD	C5H-2000LD	C5H-2000D		N60	0.40		
C5H-1340EMTD	C5H-1340LD	C5H-1340D		PEAK	0.25		
C5H-2340EMTD	C5H-2340LD	C5H-2340D		PEAK	0.40		

Dimension in mm [Inch]

THIS DOCUMENT AND THE INFORMATION WHICH IT CONTAINS SHALL NOT BE USED, EXPLOITED OR SOLD, AND SHALL NOT BE REVEALED OR DISCLOSED TO OTHERS WITHOUT THE EXPRESS WRITTEN PERMISSION OF VICI. THIS DOCUMENT SHALL REMAIN THE PROPERTY OF VICI AND SHALL BE RETURNED UPON DEMAND.		Material	Dimensionen
Anderungen: MODIFICATIONS:		PROJEKTION	Allgemein Toleranzen
e) 25.10.05 FP #480, chg. 8 and 10 port valve b) 31.03.99 FP #138, add. information c) 18.06.99 FP #146, chg. Valve A to B d) 07.10.99 FP #170, add. C5-0006EMTD		Material	GENERAL TOLERANCES
PART NO.:	C5-***EMTD	Scale	30.06.1998 F.P.
MP-micro elec. act. with dual-drive gearbox		Checked/Released	26.10.2005 FCo
Masstab SCALE 1:1		CAD Nr. / CAD NO.	506301.DWG
Unterverz.: SUB DIRC.: KUNDE		Zeichnungs Nr. / DRAWING NO.	
VICI® VICI AG International, CH-6214 Schenkon		2-GE-5063.01 e	